

# Lazy Man's Scroll Saw Bench

*By Michael Martin*

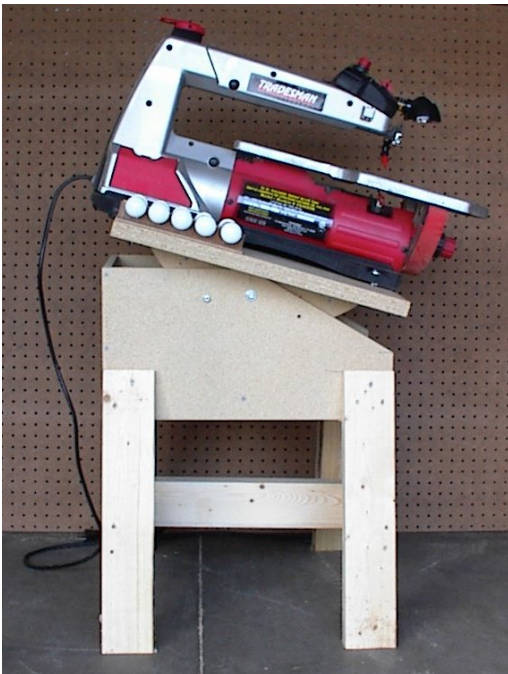

I designed this bench basically so I could get comfortable every once in a while when I'm scrolling. When I get tired of standing at my other scroll saw, I pull up a chair and continue on this one!

Everything is made out of the cheapest material I could find. All 2x4's were construction grade, and the sides and top were 1/2" particle board from a packing crate. It could look a little better with better materials, but it does the job!

It's designed to fit a saw with the table height of 7-1/2". You will need to measure and adjust the height accordingly. My suggestion would be to alter the height dimension of the box instead of the legs.

The top may have to be adjusted for your machine also. You will note that the scroll saw on it now seems a little long for the top. That's because this isn't the original saw that was on it. I just drilled new holes and mounted this one instead of building a new top.

I don't have step by step instructions and pictures, but it is pretty simple. I used 1/4" bolts and deck screws and plenty of Titebond 2 glue thru out.

The order that I used was:

- Cut out all parts
- Build the 2x4 box frame
- Attach the legs and support members
- Bolt on the table support swivels (the half moon things)
- Position and attach the table cross supports (more on this later)
- Glue the 2 pieces of the table top together (this can be done at any time)
- Position the top, centered both directions, and glue and screw it to the supports
- Bolt on the scroll saw
- Tilt the table to the most comfortable working position and C-clamp it in position.
- Drill a hole thru the side and support for a 1/4" bolt to hold it in that position. You could make up an elaborate clamp if you wanted to change position again, but hey, I'm lazy, so I would just drill another hole!

Now, on the cross supports, I just lined them up where the ends were covered by the swivels and screwed them down.

These are just the basic plans. Feel free to modify! I would like to hear from anyone that may have suggestions, or might actually build one! My e-mail is [cptnmike@yahoo.com](mailto:cptnmike@yahoo.com).

Thanks for looking! Plans follow.

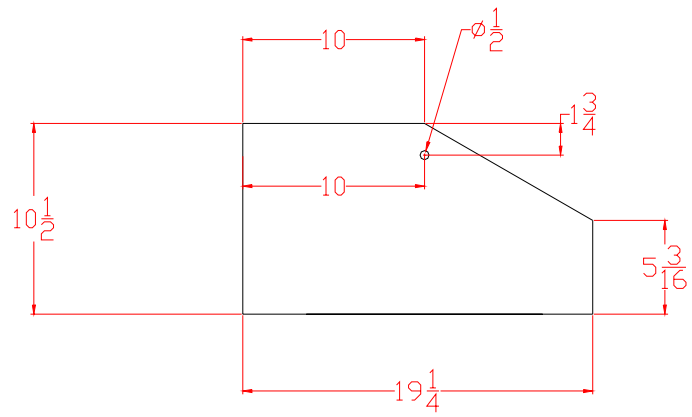
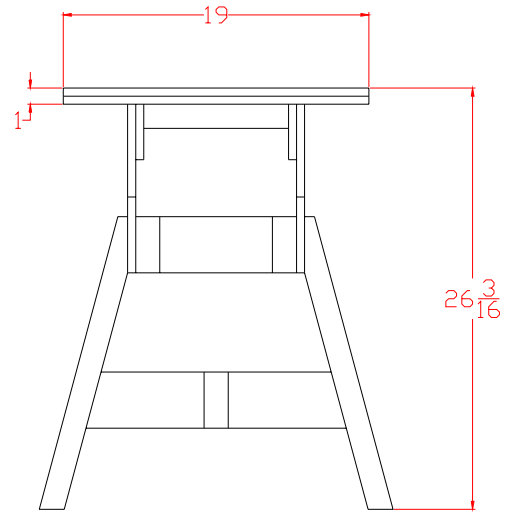
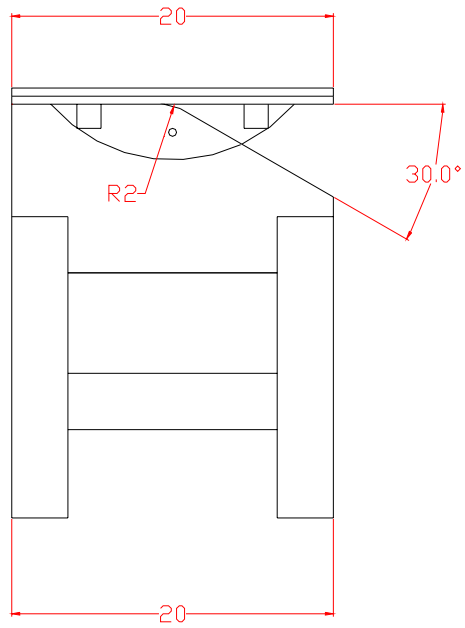

Sides  
 1/2" particleboard  
 (2 pc.)

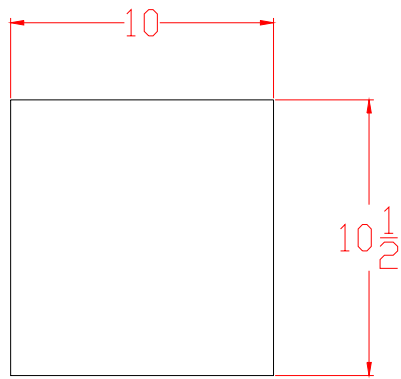

Stand Back  
1/2" particleboard  
(1 pc.)

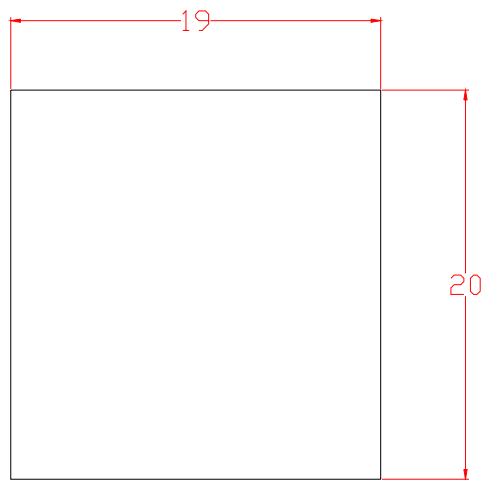

Top  
1/2" particleboard  
(2 pc.)

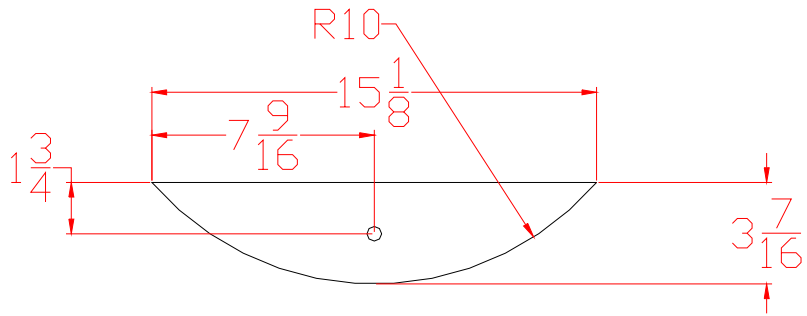

Side brackets  
 1/2" particleboard  
 (2 pc.)

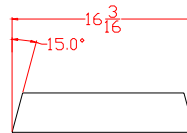

Leg Braces (2)

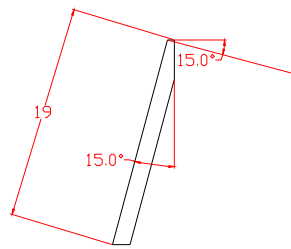

Legs (4 pcs.)

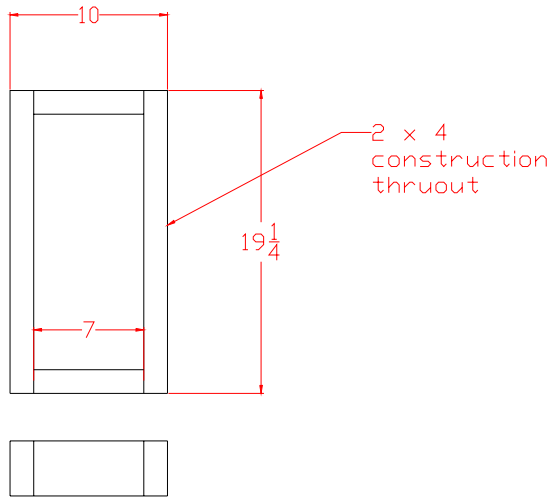

Bottom Framework (1)

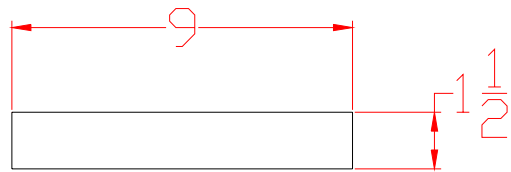

Table Braces  
 1-1/2" sq.  
 (2 pc.)